

STANDARD DROP DETAIL

TRANSITE COLLAR ENCASED
IN NON-SHRINK GROUT
FLUSH WITH MANHOLE WALL
(SEE NOTE 2)

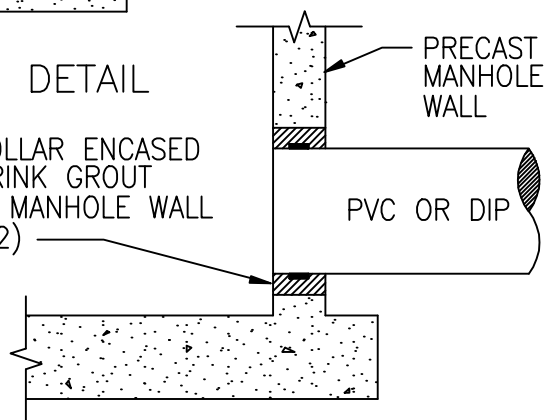

SPECIAL DETAIL FOR 24" DIAMETER
PIPE AND LARGER

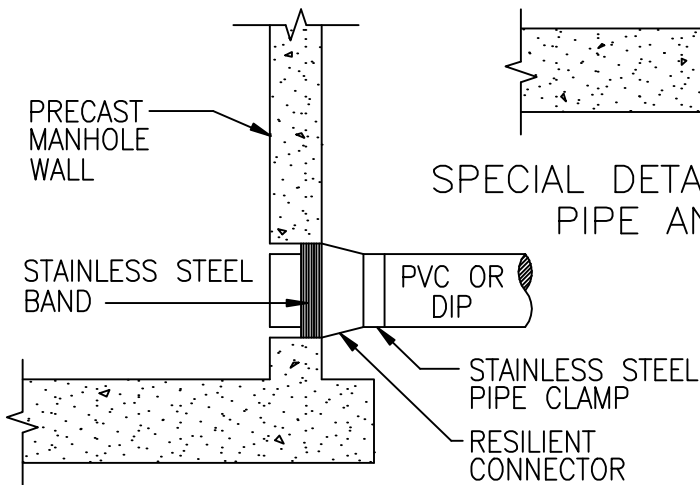

STANDARD PRECAST MANHOLE
PIPE CONNECTION

NOTES:

1. DROP PIPE AND FITTINGS SHALL BE OF EQUAL SIZE AND MATERIAL AS THE INFLUENT SEWER.
2. THE CITY MAY APPROVE ALTERNATE WATER TIGHT CONNECTION DETAILS FOR CONNECTION OF 24" DIAMETER PIPES AND LARGER.
3. AN OUTSIDE DROP CONNECTION SHALL BE REQUIRED FOR ALL INFLUENT LINES WHICH HAVE AN INVERT 2' OR MORE ABOVE THE MANHOLE INVERT.

CITY OF OCOEE UTILITIES DEPARTMENT		
MANHOLE CONNECTION DETAILS		
DATE:	DWG: MHCON	FIG: 201